



t h e

75



Z T

o w n e r s c l u b



## Front Brake Pads Removal and Refitting

**IMPORTANT:** Brake pads must be renewed in axle sets only; otherwise braking efficiency may be impaired.

### Remove

1. Raise front of vehicle.

**WARNING:** Do not work on or under a vehicle supported only by a jack. Always support the vehicle on safety stands.

2. Remove road wheel(s).

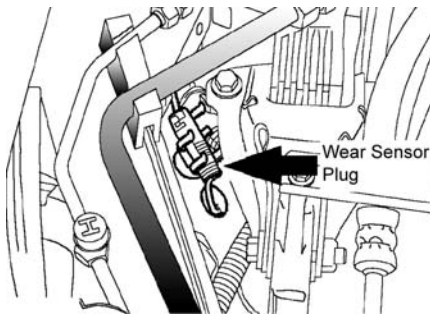

3. *RH side only:* Disconnect pad wear sensor multiplug.

4. *RH side only:* Release grommet from wheel arch liner, then release pad wear sensor lead from clips, brake hose bracket and bleed screw dust cap.

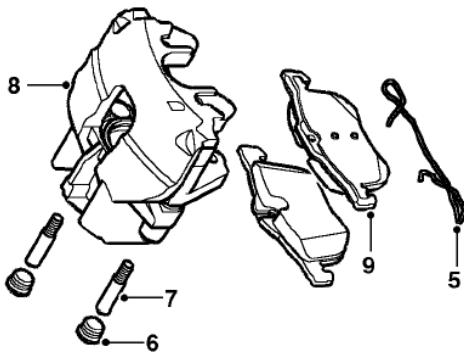
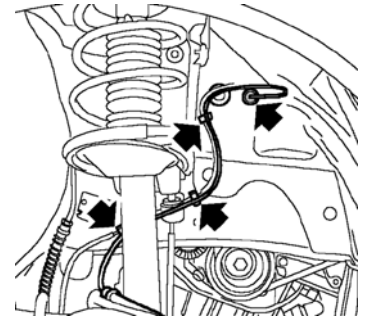

5. Remove anti-rattle spring from calliper housing.

6. Remove 2 caps from guide pin dust covers.

7. Remove 2 guide pins from calliper housing.

8. Release calliper housing from calliper carrier and tie aside.

**CAUTION:** Do not allow calliper to hang on brake hose.

9. Remove brake pads from calliper housing.

**Refit:**

1. Remove any scale and loose corrosion from around edge of disc.
2. Clean calliper housing and calliper carrier using brake cleaning fluid.

**WARNING: Do not use compressed air to clean brake components. Dust from friction materials can be harmful if inhaled.**

3. Inspect calliper and seals for damage.
4. Position bleed bottle, connect bleed hose to bleed screw and loosen screw.
5. Press piston into calliper housing then tighten bleed screw to 5 Nm.
6. Disconnect bleed hose and remove bottle.
7. Secure cap to bleed screw.
8. Fit brake pads to calliper housing. On RH brakes, ensure pad wear sensor is connected to pad.
9. Lubricate guide pins with suitable anti-seize grease.
10. Position calliper housing to calliper carrier and align. Fit guide pins and tighten to 28 Nm.
11. Fit caps to guide pin dust covers.
12. Fit anti-rattle spring clip to calliper housing.
13. RH *side only*: Secure pad wear sensor lead to bleed screw dust cap, brake hose bracket and clips. Install grommet in wheel arch liner and connect multiplug.
14. Depress brake pedal several times to seat pads.

**NOTE: Pedal travel may be longer than normal during first brake applications.**

15. Check/top up brake fluid reservoir.
16. Fit road wheel(s) and tighten bolts to 125Nm.
17. Remove stand(s) and lower vehicle.